

Drill-Jigs

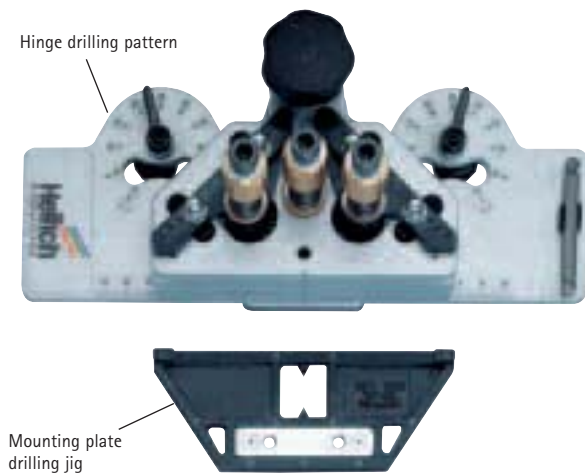

Article	For hole dimensions	Order no.	PU
Drill-Jig hinge TB 43	35 / 2 x 8	047 303	1 set
TB 42	35 / 2 x 2,5	047 307	1 set

Set contains:

- 1 drilling template for hinges
- 1 drilling template for mounting plates
- 1 hexagonal driver
- 1 drill bit, \varnothing 35 mm
- 2 drill bit, \varnothing 8 or 2,5 mm

Drill-Jig hinge

Hinge installation made easy: with a standard commercially available power drill and the **Drill-Jig hinge**, hole patterns can be made everywhere – simply, rationally and precisely.

Regardless whether you are retrofitting doors on pre-installed shelves or blind panels, for individual or special applications, the **Drill-Jig hinge** eliminates the need for unprofitable and time-consuming machine adjustment – simply drill and fit, and that's it.

- Precise and clean hole drilling for hinges and mounting plates
- Angled, precise drilling with tungsten carbide tipped drill bits
- No "runaway" of the drill bit when cut-drilling half-moon holes

Drill-Jig hinge can be used for:

- Hettich Intermat, Ecomat and Optimat hinges with hole dimensions TB 43 and TB 42

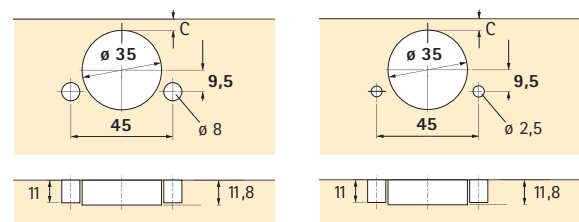

- Mounting plate series System 9000

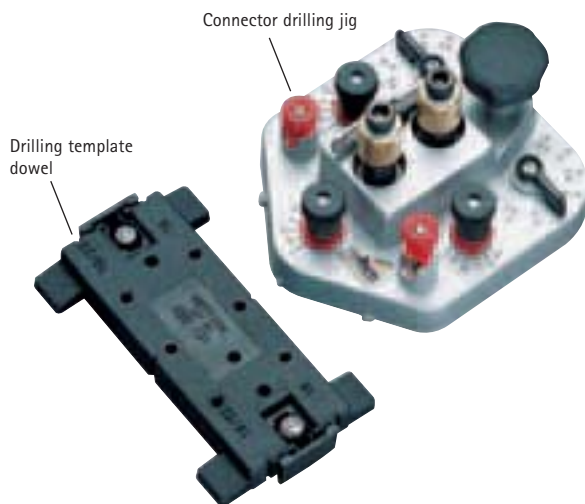

Article	Order no.	PU
Drill-Jig VB	020 166	1 set

Set contains:

- 1 drilling template for VB connecting fittings
- 1 drilling template for dowels
- 1 drill bit \varnothing 10 mm
- 1 drill bit \varnothing 20 mm for VB 35/35M/36/36M and VB135
- 1 hexagonal driver

Drill Jig VB for connecting fittings

All you need for rapid, rational, simple and at the same time precise installation of Hettich connecting fittings is the **Drill-Jig VB** drilling jig and a standard commercially available power drill.

- For retrofitting structural shelves and panels
- Single or special production
- Precise, clean and also angled holes
- Tungsten carbide tipped bits
- No "runaway" of the drill bit when cut-drilling half-moon holes
- Holes spaced at regular 32 mm intervals
- Fixed end stop at 37 mm (= distance between hole line and front side edge)
- Drilling diameter 5 mm
- For wood thickness of 16/19 and 22 mm

Drill-Jig VB can be used for :

- Connecting fittings VB 35/35M/36/36M
- Connecting fitting VB 135